

Jetson M1





Jetson M1

A one-person pod, ideal as a tranquil spot for solo, hands-on work. A cozy, soundproof oasis where you can focus and get things done.

Jetson is a family of universal acoustic pods designed to make everyone's work joyful and fruitful. It's truly people-focused: comfortable and customizable through add-on sets to meet your need and vision. Made of extruded aluminum, which makes it the lightest and most environmentally-friendly pod on the market. With its durable construction, no-hassle assembly, effective sound attenuation, and attractive price, Jetson will introduce the benefits of acoustic pods to all.

FUNCTION

Videocall or focused work

ACOUSTICS

Insulation

USAGE

Open space

Reception

Breakout area

Other public spaces

Dimensions, weight & features

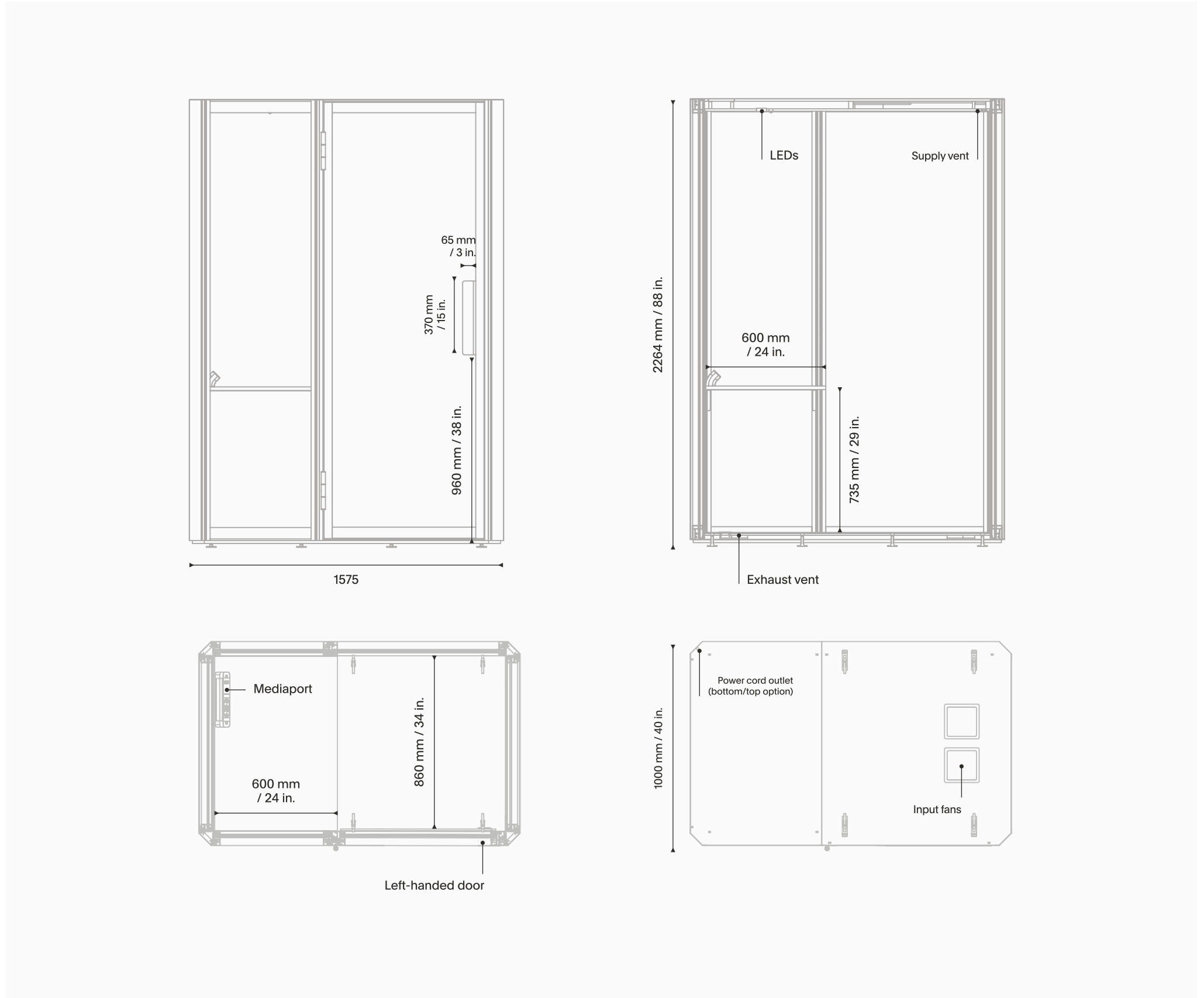

DIMENSIONS [MM IN.]	EXTERIOR / INTERIOR	WEIGHT [KG LBS]
Width	1575 / 1435 62 / 56	Pod 275 606
Depth	1000 / 860 40 / 34 + 800 32 with an open door	Tabletop 6 13
Height	2264 / 2102 88 / 83	Deep shelf 2,3 5
Tabletop [w x d x h]	600 × 855 × 734	Shallow shelf 1,5 3
	24 × 34 × 29	Display rail 1,4 3

Technical data

ACOUSTIC RESULTS AND VENTILATION

Sound insulation	up to 44,7 dB
Reverberation time	0,2 s
Nominal airflow	365 m ³ /h
Fan noise outside / inside	≤36 dB / ≤38 dB

POWER SUPPLY AND CONSUMPTION

Working (fan, LEDs)	40 W
Power supply voltage	220-240 / 100-120 VAC, 50-60 Hz
Power sockets in a mediaport	2
USB fast charger in a mediaport	TUF A+C 30 W, 5 V DC
LAN port	Posiibility to route the LAN cable
Available socket types	FR / DE / UK / US / CH / AU / DK* / IT*

*The appearance of the media port may differ from that shown in the renderings. Parameters and features remain unchanged.

COMPOSITION

Aluminium structure and steel elements
 Plywood and melamine faced chipboard
 Isolating and absorbing materials
 Tempered glass
 Felt

STANDARD EQUIPMENT SET

Ventilation system
 LED lighting
 Occupancy sensor
 Media port with 2 power and A+C USB sockets
 Melamine tabletop
 Shallow shelf with display rail and magnet
 2× wall hook
 Power cord 3 m | 118 in.

CERTIFICATES AND TESTS

ISO 14001, ISO 9001
 VOC and Formaldehyde tested
 Speech reduction tested
 Reaction to fire tested

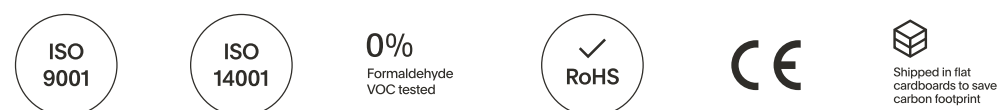

OPTIONAL EQUIPMENT

Monitor hanger 837 × 429 mm | 33 × 17 in.
 Max load: 50 kg | 110 lbs
 VESA standard 100/200/300

Add-on sets

Library set

Weight / with packaging 6,5 / 8 kg | 14 / 18 lbs

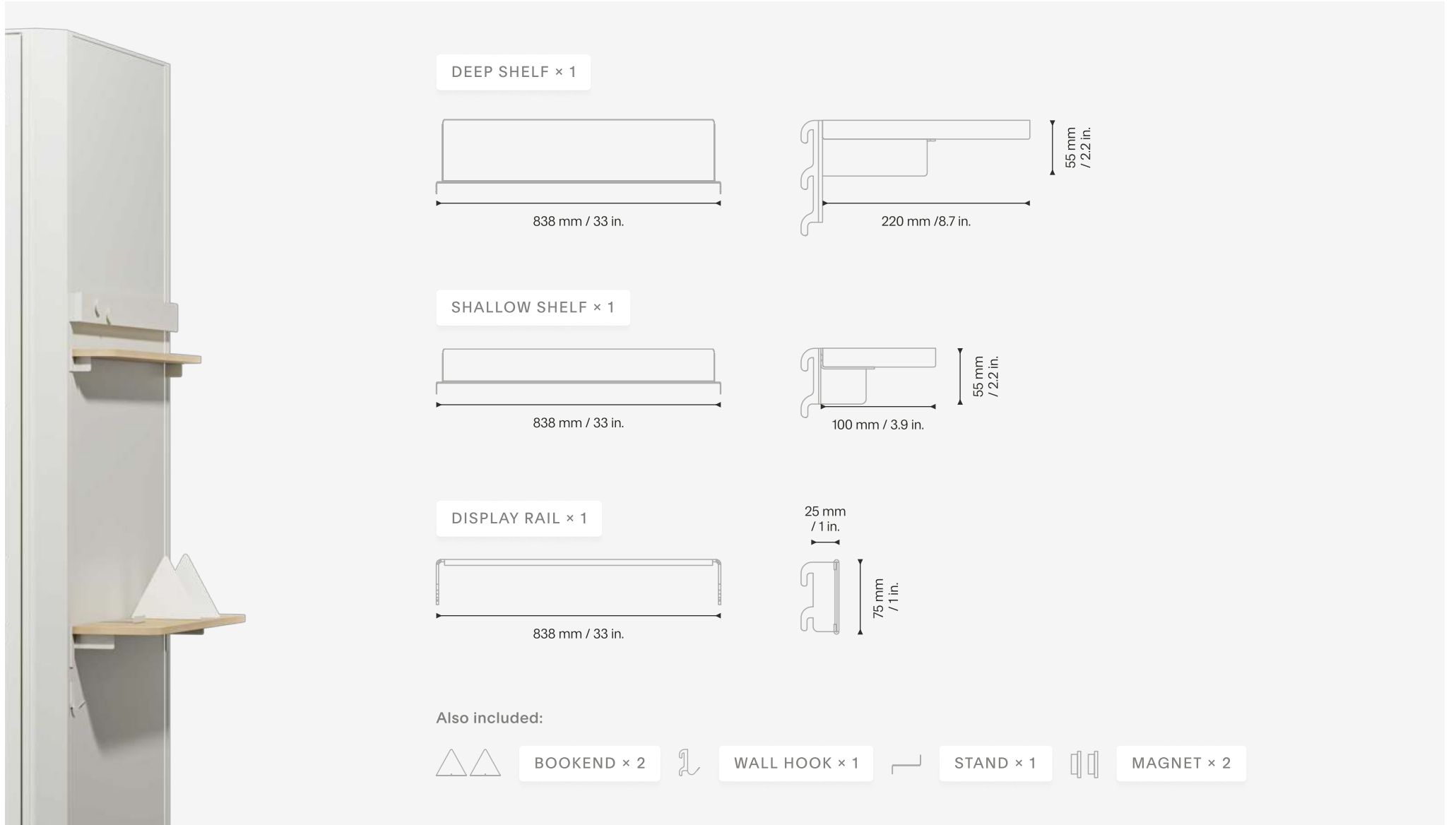

DEEP SHELF × 1

838 mm / 33 in.

220 mm / 8.7 in.

55 mm / 2.2 in.

SHALLOW SHELF × 1

838 mm / 33 in.

100 mm / 3.9 in.

55 mm / 2.2 in.

DISPLAY RAIL × 1

838 mm / 33 in.

25 mm / 1 in.

75 mm / 1 in.

Also included:

BOOKEND × 2

WALL HOOK × 1

STAND × 1

MAGNET × 2

Note set

Weight / with packaging 10 / 12 kg | 22 / 26 lbs

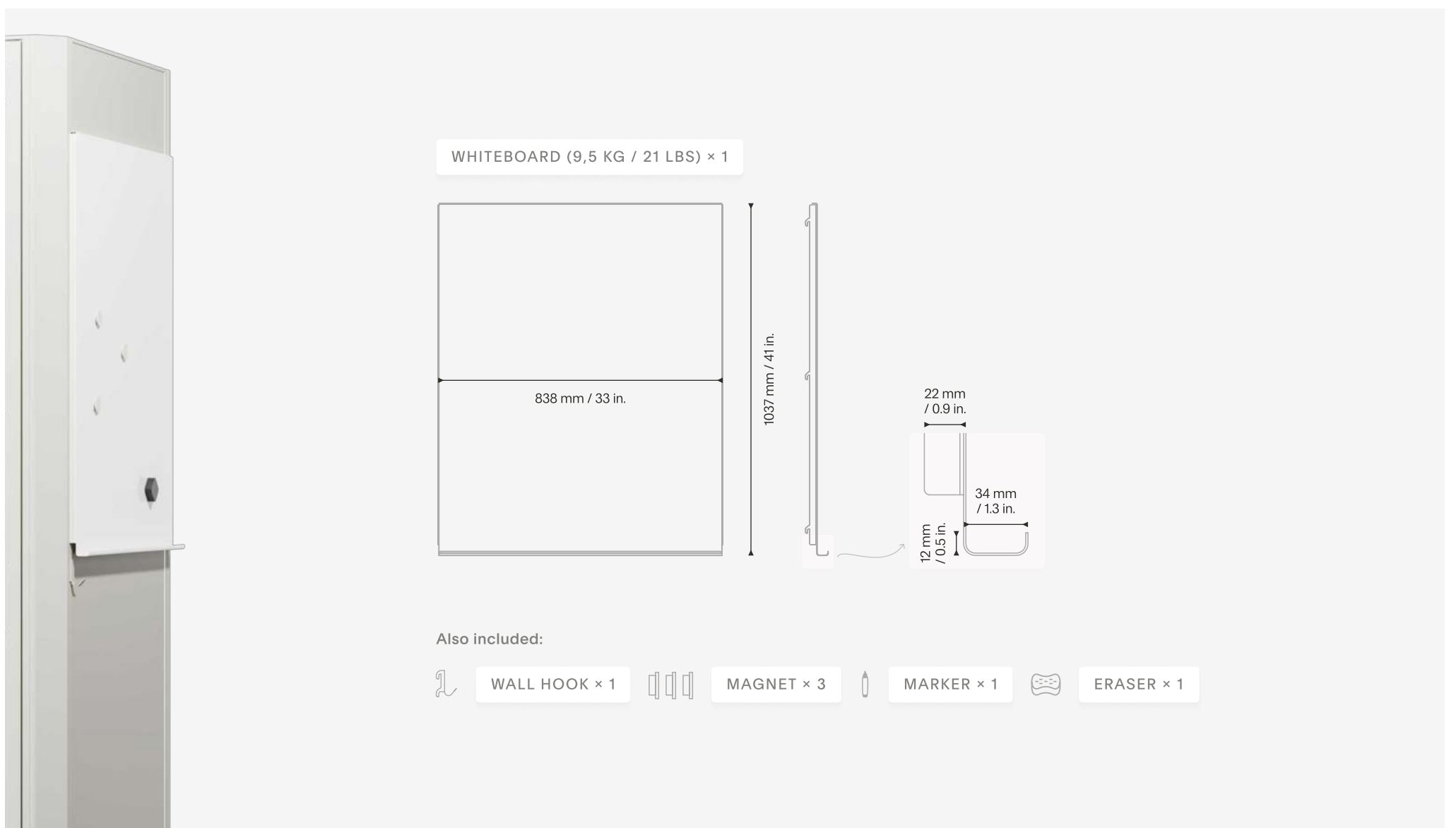

WHITEBOARD (9,5 KG / 21 LBS) × 1

838 mm / 33 in.

1037 mm / 41 in.

22 mm / 0.9 in.

34 mm / 1.3 in.

12 mm / 0.5 in.

Also included:

WALL HOOK × 1

MAGNET × 3

MARKER × 1

ERASER × 1

Finishes overview



1 EXTERIOR WALLS AND FRAME

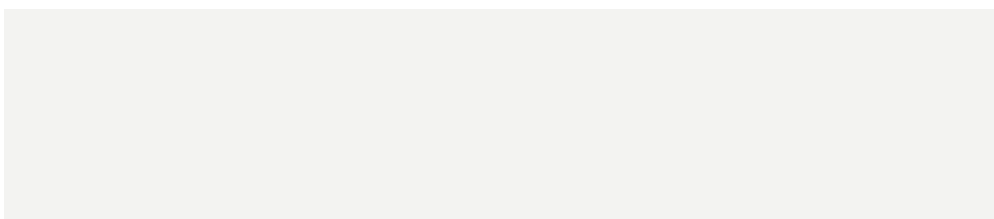

Moon White, PANTONE GREY 403051

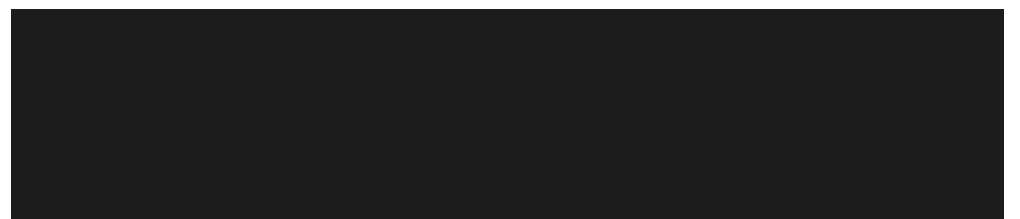

Void Black, NCS S8500-N

2 INTERIOR WALLS AND CEILING

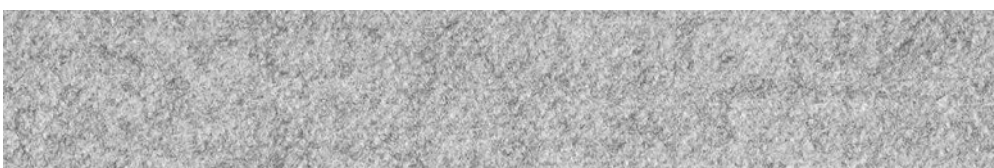

Light gray felt

3 TABLETOP AND SHELVES



Oak wood melamine, H1334 ST9

4 BOOKENDS AND MAGNETS



Matching walls color

5 FLOOR

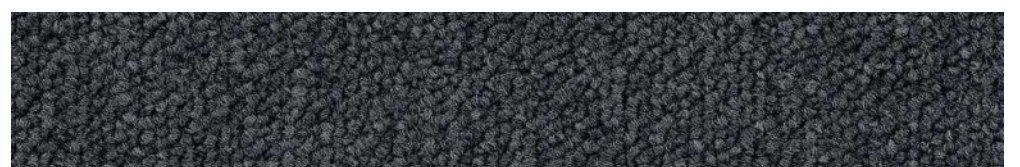

Dark gray carpet